

Refer to *Important Safety Precautions* on page 33.

Using the proper oil and oil filter, and regularly checking, adding, and changing oil will help extend the service life of the engine. Even the best oil wears out. Changing oil helps get rid of dirt and deposits. Operating the engine with old or dirty oil can damage your engine. Running the engine with insufficient oil can cause serious damage to the engine.

Change the engine oil as specified in the maintenance schedule on pages 36, 37.

When running in very dusty conditions, oil changes should be performed more frequently than specified in the maintenance schedule.

When riding at high or continuous speed on the highway, check the oil level frequently.

## Oil Recommendation

API classification	SG or higher except oils labeled as energy conserving or resource conserving on the circular API service label
viscosity (weight)	SAE 10W-30
JASO T 903 standard	MA
suggested oil*	Pro Honda GN4 4-stroke Oil (USA & Canada), or Honda 4-stroke oil, or an equivalent motorcycle oil

\* Suggested 4-stroke engine oils are equal performance to SJ oils that are not labeled as energy conserving or resource conserving on the circular API service label.

- Your motorcycle does not need oil additives. Use the recommended oil.
- Do not use API SH or higher 4-stroke engine oils displaying a circular API “energy conserving” or “resource conserving” service label on the container. They may affect lubrication.

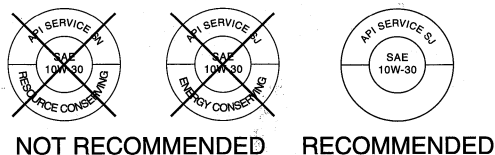

Other viscosities shown in the following chart may be used when the average temperature in your riding area is within the indicated range.

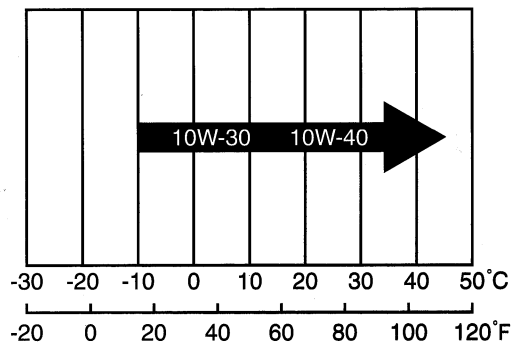

## JASO T 903 standard

The JASO T 903 standard is an index for engine oils for 4-stroke motorcycle engines. There are two classes: MA and MB. Oil conforming to the standard is labeled on the oil container. For example, the following label shows the MA classification.

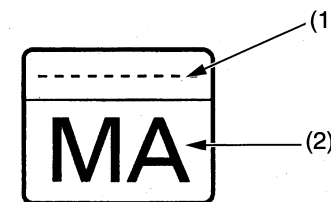

- (1) oil code
- (2) oil classification

# Engine Oil

## Checking & Adding Oil

1. Run the engine at idle for 3 minutes, then shut it off.
2. Wait 3 minutes after shutting off the engine to allow the oil to properly distribute itself in the engine.
3. Support the motorcycle in an upright position on a level surface.
4. Remove the engine oil fill cap/dipstick (1) from the left crankcase cover, wipe it clean, and insert it without screwing it in. Remove the oil fill cap/dipstick.
5. Check that the oil level is between the upper (2) and lower (3) level marks on the engine oil fill cap/dipstick.
  - If the oil is at or near the upper level mark, you do not have to add oil.
  - If the oil is below or near the lower level mark, add the recommended oil until it reaches the upper level mark. (Do not overfill.)Reinstall the engine oil fill cap/dipstick. Repeat steps 1 – 5.

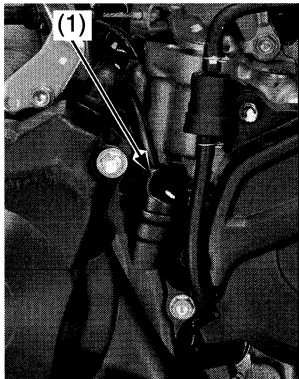

- (1) engine oil fill cap/dipstick  
(2) upper level mark  
(3) lower level mark

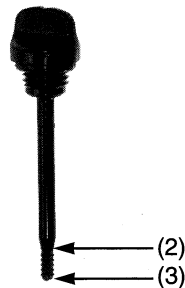

6. Check that the O-ring (4) is in good condition and replace it if necessary.
7. Reinstall the engine oil fill cap/dipstick (1).

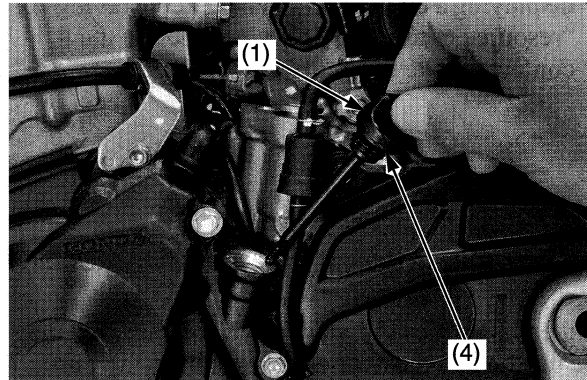

- (1) engine oil fill cap/dipstick  
(4) O-ring

8. Check for oil leaks.

## Changing Engine Oil & Filter

1. Remove the engine guard A bolts/washers (1), B bolt/washer (2) and engine guard (3).

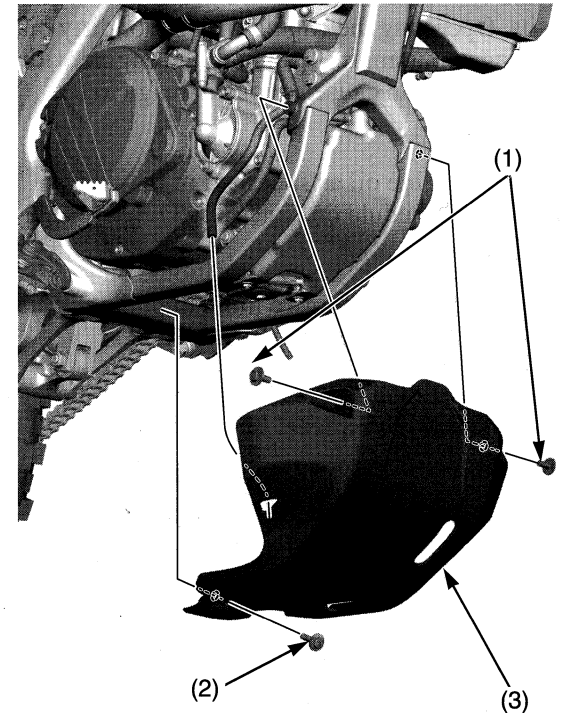

- (1) engine guard A bolts/washers  
(2) engine guard B bolt/washer  
(3) engine guard

2. Run the engine at idle for 3 minutes, then shut it off.
3. Support the motorcycle in an upright position on a level surface.
4. Remove the engine oil fill cap/dipstick (4) from the left crankcase cover.

5. Place an oil drain pan under the engine to catch the oil. Then remove the engine oil drain bolt (5) and O-ring (6).
6. After the oil has drained, apply engine oil to the drain bolt threads, seating surface and a new O-ring, then install the O-ring on the drain bolt and tighten the drain bolt to the specified torque:  
13 lbf·ft (18 N·m, 1.8 kgf·m)

Pour the drained oil into a suitable container and dispose of it in an approved manner (page 160).

## NOTICE

*Improper disposal of drained fluids is harmful to the environment.*

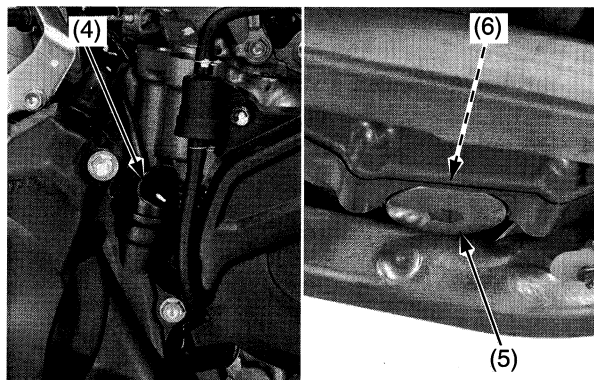

- (4) engine oil fill cap/dipstick
- (5) engine oil drain bolt
- (6) O-ring (new)

7. (Off-Road Use)  
It is recommended to replace the oil and filter every 8 races or about every 30.0 hours. However, if you replace only the oil before the recommended interval, see page 36.
8. Remove the left crankcase over cover bolts (7) and over cover (8).

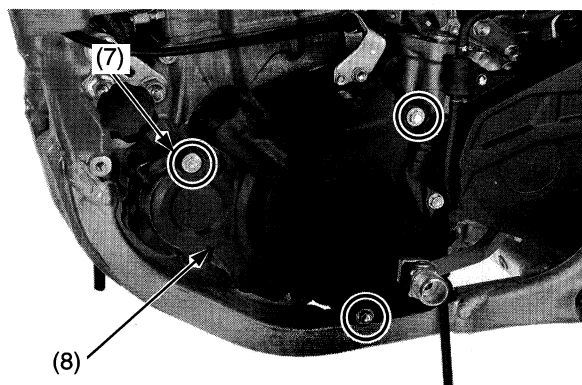

- (7) bolts
- (8) over cover

9. Remove the oil filter cover bolts (9) and oil filter cover (10).
10. Remove the oil filter (11), O-ring (12) and spring (13).

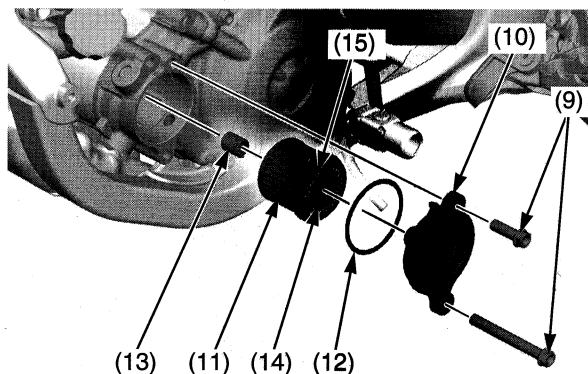

- (9) oil filter cover bolts
- (10) oil filter cover
- (11) oil filter
- (12) O-ring
- (13) spring
- (14) rubber seal
- (15) "OUT-SIDE" mark

## NOTICE

*Using the wrong oil filter may result in leaks or engine damage.*

11. Apply grease to the filter side of the spring end, then install the spring into a new oil filter.

12. Position the spring against the engine crankcase and install a new oil filter with the rubber seal (14) facing out, away from the engine. You should see the "OUT-SIDE" mark (15) on the filter body, near the seal. Use a new Honda Genuine oil filter or a filter of equal quality specified for your model.

## NOTICE

*If the oil filter is not installed properly, it will cause serious engine damage.*

13. Apply engine oil to a new O-ring and install it to the oil filter cover.
14. Install the oil filter cover being careful not to damage the O-ring, then tighten the oil filter cover bolts to the specified torque:  
7 lbf·ft (10 N·m, 1.0 kgf·m)
15. Install the left crankcase over cover, then tighten the over cover bolts to the specified torque:  
7 lbf·ft (10 N·m, 1.0 kgf·m)
16. Install the engine guard, then tighten the engine guard A bolts/washers and B bolt/washer to the specified torque:  
7 lbf·ft (10 N·m, 1.0 kgf·m)
17. Fill the crankcase with the recommended oil.  
Capacity: 1.22 US qt (1.15 ℓ)  
after draining and filter change  
1.16 US qt (1.10 ℓ)  
after draining
18. Install the engine oil fill cap/dipstick.
19. Check the engine oil level by following the steps in *Checking & Adding Oil* (page 70).

Pour the drained oil into a suitable container and dispose of it in an approved manner (page 160).

## NOTICE

*Improper disposal of drained fluids is harmful to the environment.*